

N.C. GAS SOLENOID VALVES WITH RESET

GRC Eng.

- Body in diecast aluminium
- NBR seals
- Screwed (DN 1/2" to 2") connections
- Flanged PN 16 (DN 65 to 100) connections



1. APPLICATION

Used, in conjunction with safety systems, for shut-off in gas feed pipes.

2. OPERATION

They can be opened only manually and remain open only if powered ; without power they close.
Ideal for continuous service (always powered).



3. MODELS

Code	Connect. DN	Power supply	Consum. W	P.max ⁽¹⁾ mbar	Orifice Ø mm	Flow m ³ /h ⁽²⁾		Certification (Min. of Interior)
						0.5 mbar	1 mbar	
GRC 815	scr.d 1/2"	230 V ~	25	500	18	2.8	4	3704/1217/87/215
GRC 415	scr.d 1/2"	24 V ~/-	25	500	18	2.8	4	
GRC 215	scr.d 1/2"	12 V ~/-	12	500	18	2.8	4	
GRC 820	scr.d 3/4"	230 V ~	25	500	27	5.5	8	3704/1217/87/215
GRC 420	scr.d 3/4"	24 V ~/-	25	500	27	5.5	8	
GRC 220	scr.d 3/4"	12 V ~/-	12	500	27	5.5	8	
GRC 825	scr.d 1"	230 V ~	25	500	27	8.3	13	3704/1217/87/215
GRC 425	scr.d 1"	24 V ~/-	25	500	27	8.3	13	
GRC 225	scr.d 1"	12 V ~/-	12	500	27	8.3	13	
GRC 832	scr.d 1 1/4"	230 V ~	25	500	45	14	20	3704/1217/87/215
GRC 432	scr.d 1 1/4"	24 V ~/-	25	500	45	14	20	
GRC 232	scr.d 1 1/4"	12 V ~/-	12	500	45	14	20	
GRC 840	scr.d 1 1/2"	230 V ~	25	500	45	19	28	3704/1217/87/215
GRC 440	scr.d 1 1/2"	24 V ~/-	25	500	45	19	28	
GRC 240	scr.d 1 1/2"	12 V ~/-	12	500	45	19	28	
GRC 850	scr.d 2"	230 V ~	25	500	56	27	40	3704/1217/87/215
GRC 450	scr.d 2"	24 V ~/-	25	500	56	27	40	
GRC 250	scr.d 2"	12 V ~/-	12	500	56	27	40	
GRC 865	flang. 65	230 V ~	25	500	80	55	80	3704/1217/87/215
GRC 465	flang. 65	24 V ~/-	25	500	80	55	80	
GRC 265	flang. 65	12 V ~/-	25	500	80	55	80	
GRC 880	flang. 80	230 V ~	25	500	80	73	100	3704/1217/87/215
GRC 480	flang. 80	24 V ~/-	25	500	80	73	100	
GRC 280	flang. 80	12 V ~/-	25	500	80	73	100	
GRC 8100	flang. 100	230 V ~	45	500	100	110	160	3704/1217/87/215
GRC 4100	flang. 100	24 V ~/-	45	500	100	110	160	
GRC 2100	flang. 100	12 V ~/-	45	500	100	110	160	

(1) – Maximum working pressure

100 mbar = 10 kPa = 1,000 mm WG

(2) – Natural gas flow with pressure drop of 0.5 mbar (5mmWG) and 1 mbar (10 mmWG)

4. TECHNICAL DATA

Power supply	230 V ~, 24 - 12 V ~/-	Closure time	≤ 1 s
Voltage tolerance	- 15 to + 10 %	Ambient temperature	- 15 °C to + 60 °C
Consumption (see table)	12 to 45 W	Construction :	
Protection	IP 54	- valve body	diecast aluminium
Cable entry gland	PG 11	- seals	NBR (UNI 4916 -74)
Connections :		- pressure spring	AISI 302 steel
GRC ..15 to ..50	Female screwed	- plug	chromium- plated Fe 37 steel
GRC ..65 to ..100	Flanged PN16		

5. INSTALLATION

- It is preferable to position the valve downstream of the gas meter and outside the area traversed by the gas pipework.
- If positioned in the open air it must be protected from rain.
- Ensure that in the pipework there are no residues from soldering or from tapping or threading.
- Check the alignment of the pipework connections and ensure that they are not subject to vibrations.
- Pay attention to the flow direction marked on the valve body.
- Valve can be installed in any position except that with the coil facing downwards.
- Leave sufficient space for any future removal of the coil and around the valve itself for the circulation of air.
- Avoid absolutely using the coil as a lever; instead use appropriate tools on the seating of the valve body.
- On completion of the installation check the seals.
- Power the coil and pull up the reset knob to open the valve.

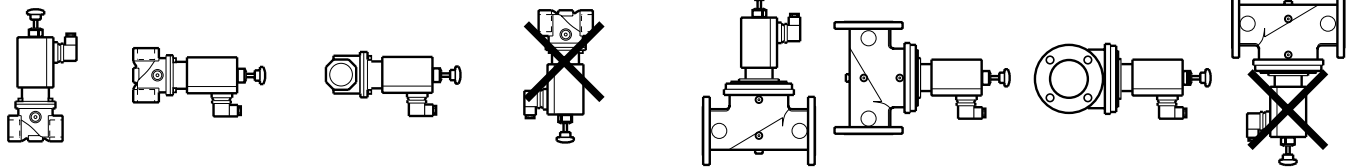

6. PRESSURE DROP

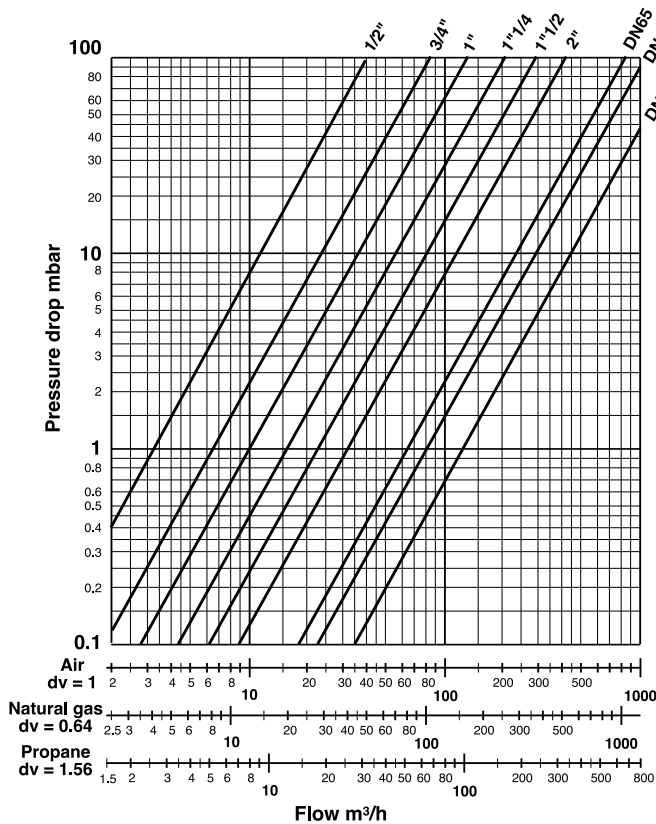

7. OVERALL DIMENSIONS

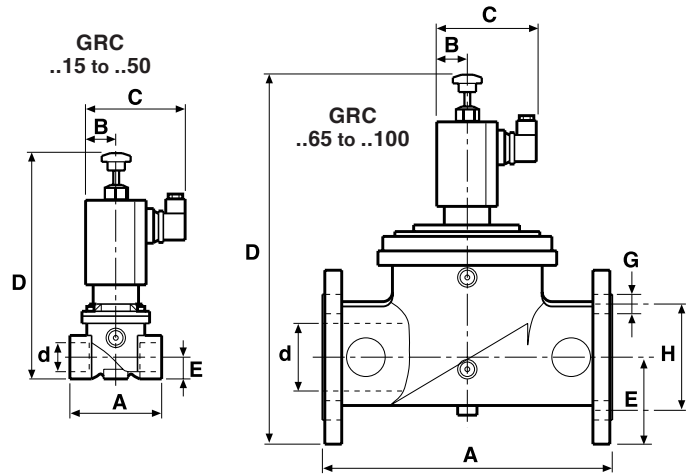

Type	d DN	A mm	B mm	C mm	D mm	E mm	G mm	H mm	Wt kg
..15	1/2"	77	22	83	164	18	-	-	1.1
..20	3/4"	96	22	83	180	25	-	-	1.5
..25	1"	96	22	83	180	25	-	-	1.5
..32	1 1/4"	153	22	83	220	35	-	-	2.4
..40	1 1/2"	153	22	83	220	35	-	-	2.4
..50	2"	156	22	83	230	39	-	-	2.7
..65	65	305	22	83	340	90	4 x 18	145	7.6
..80	80	305	22	83	340	90	8 x 18	160	7.6
..100	100	350	40	110	405	130	8 x 18	180	17.0

8. ELECTRICAL CONNECTIONS & MAINTENANCE

The twin-wire power cable must be connected to the two poles of the rectifier terminal block housed in the union. On the junction box of the valves GRC 4100 (24 V) and GRC 2100 (12 V) there are two inputs marked with the symbols "L, N" and "+, -" :

- with alternating current connect to input "L, N" ,
- with direct current connect to terminals "+, -" , according to polarity.

To remove the coil, first switch off the power and turn off the gas then unscrew the reset knob and the round knurled nut on top of the coil housing.

In many cases the coils damaged by excessive voltages have only one or more rectifier diodes burnt out; if the resistance at the heads of the winding is 3,250 Ω, replace only the rectifier.

WARNING : during normal operation of the gas valve the surface temperature of the coil can reach 70 °C, careful consideration must be taken when selecting suitable supply cables and the positioning of the valve in relation to surrounding materials.

RZ 15.02.02 Rev. : MZ 07.06.04



Head Office & Sales
Via San G.B. De La Salle, 4/a Tel. +39 022722121
20132 - Milan Fax +39 022593645

Reg. Off. Central & Southern
Via S. Longanesi, 14 Tel. +39 065573330
00146 - Roma Fax +39 065566517

Orders and Shipping
Via Gen. Trebaldi, 190/192 Tel. +39 0364773200
25048 - Edolo (BS) Tel. +39 0364773202
Fax +39 0364770016

E-mail: info@coster.info Web: www.coster.info



D 33084