

AUXILIARY TERMINALS FOR ACTUATORS, MODELS: CSL / CSN / CSS / CSG – CVLR / CVSR

FCS ..23

- **Terminals:**
 - 1 or 2 switchable
- **Threshold:**
 - adjustable along the entire stroke
- **Installation:**
 - directly on the actuator



1. USE

Accessories FCS ..23 are normally applied to actuators (see models listed above), as limit switch terminals, to pilot auxiliary system components in case of need .
The terminals do not have power supply (clean) and there may be 1 or 2, depending on the model used among the versions available (see table below).

2. VERSIONS

Ref.	Number of terminals	Max applicable tension	Terminal load	Threshold	Installation
FCS 123	1 switchable	250 V~	3 (0.5) A	Adjustable along all the stroke	Directly on Coster actuators
FCS 223	2 switchable	250 V~	3 (0.5) A	Adjustable along all the stroke	Directly on Coster actuators

3. TECHNICAL SPECIFICATIONS

Terminals:			Ambient temperature:	
– FCS 123	see versions		– In operation	– 30...+50 °C
– FCS 223	see versions		– Shipping and storing	– 40...+80 °C
– tension and flow rate	see versions		Ambient humidity	95% (EN 60730-1)
– threshold	see versions		Protection level	IP 54
Electrical connections: (predisposed)			Weight:	
– FCS 123 (cable)	1m, 3 x 0.75 mm ²		– FCS 123	around 130 g.
– FCS 223 (cable)	1m, 6 x 0.75 mm ²		– FCS 223	around 170 g.

4. INSTALLATION

To install the auxiliary terminals on the actuator, carefully follow the instructions below; also, to aid installation, as possible the auxiliary terminal should not yet be mounted on the system.

4.1 Installation sequence for roller shutter actuators:

- Remove the position market complete with support, (see Fig.1); (if required, use a screwdriver to decouple):
- Position the block containing the terminals on the head of the actuator, (see Fig.2); bring together the two coupling teeth (obtained from a support which includes a pressure spring), which jut out from the lower part of the block, with the two perforations on the head of the fastening clamp of the roller shutter's pin, (see Fig.2a).
- After completing the above manoeuvre, press down hard on the auxiliary terminal block until it latches on firmly to the head of the actuator (see Fig.3), making sure that the two elements are fully and correctly joined; then, before mounting the actuator on the system, manually execute a full rotation, to check functioning and correct assembly.

fig.1

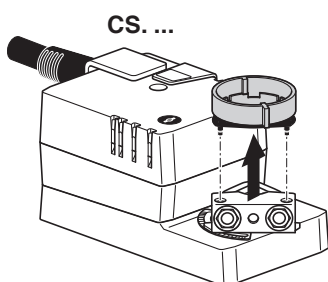

fig.2

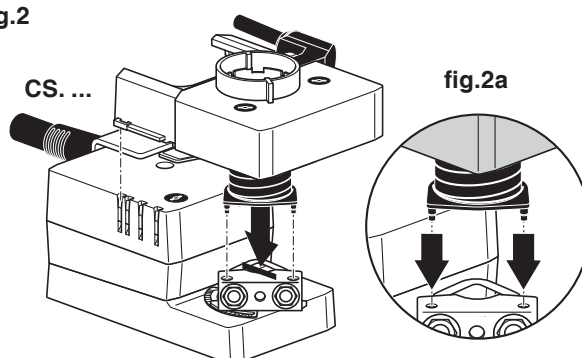
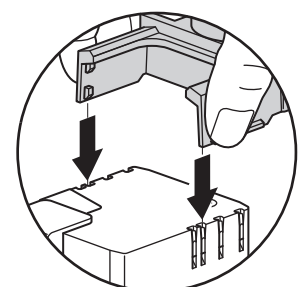

fig.3



4.2 Installation sequence for rotary valves:

WARNING: to carry out this operation, the motor must be coupled with the valve

- Remove gasket placed beneath the manual control hand-wheel, using a screwdriver (see Fig.1a); **(only for mod. CVSR... actuators).**
- Position the block containing the terminals on the head of the actuator, (see Fig.2); bring together the two coupling teeth (obtained from a support which includes a pressure spring), which jut out from the lower part of the block, with the two perforations on the adapter ring; then join (see Fig.2a).
- After completing the above manoeuvre, press down hard on the auxiliary terminal block until it latches on firmly to the head of the actuator (see Fig.3), making sure that the two elements are fully and correctly joined; then, before mounting the actuator on the system, manually execute a full rotation, to check functioning and correct assembly.

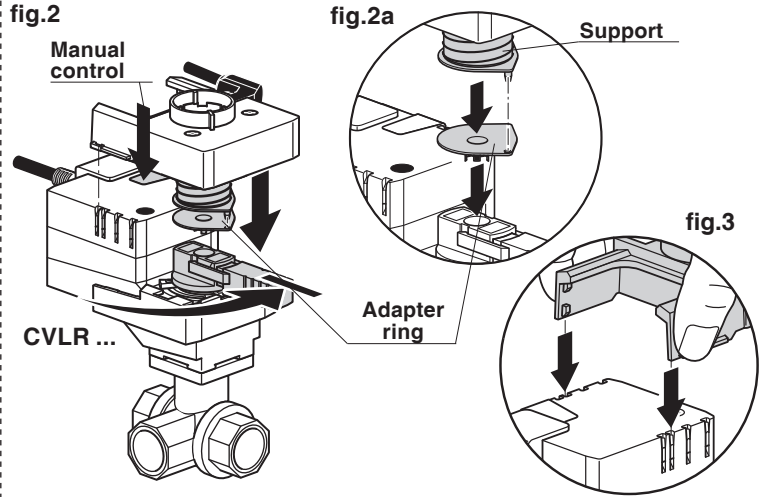
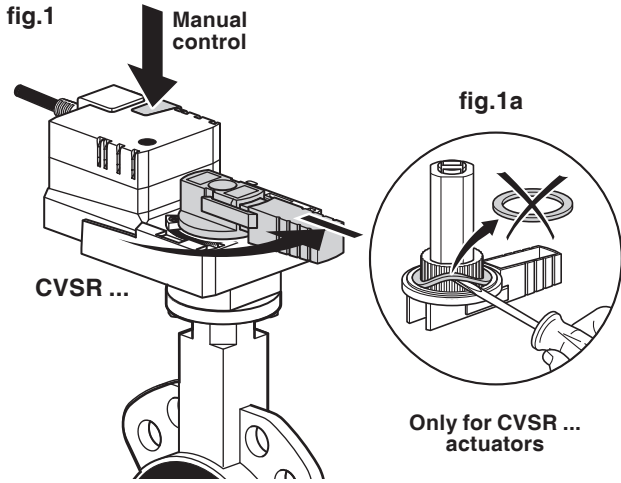

4.3 Disassembly

To disassemble the terminals block, it is essential to use a screwdriver (no pliers or similar tools). Use the screwdriver head to prise off the two wings (fig.1) that keep the block joined to the actuator head, first on one side, then on the other; the same operation must be repeated on the support; when the parts are fully disengaged, pull delicately to completely separate them (fig.2). NB: when decoupling, be very careful not to ruin the parts, which will otherwise be made unusable.

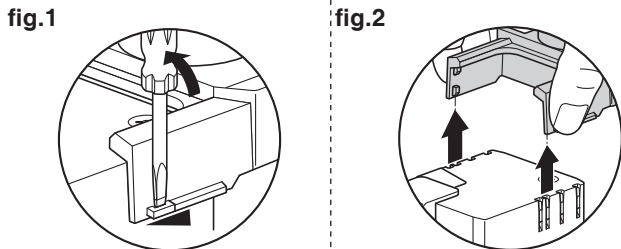

5. DIMENSIONS – DESCRIPTION

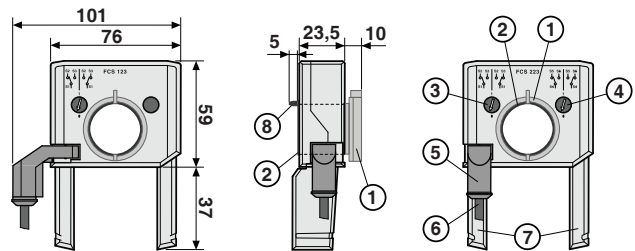

- 1 - Position marker
- 2 - Coupling teeth support
- 3 - Terminal 1: threshold adjustment
- 4 - Terminal 2: threshold adjustment
- 5 - Rotatable connector
- 6 - Electrical connection cable
- 7 - Actuator fastening wings
- 8 - Teeth for coupling with actuator

6. ELECTRICAL WIRING DIAGRAM

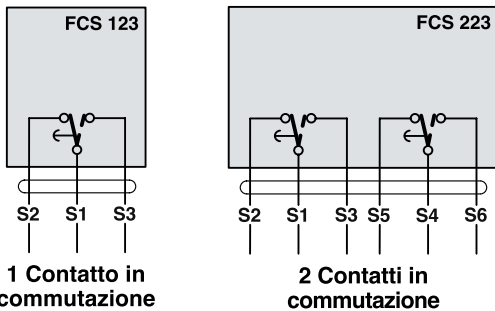

7. WIRING CONNECTOR ASSEMBLY

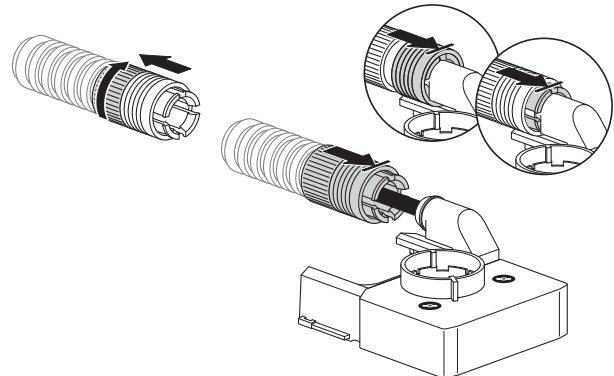

Data sheet amendment

Date	Amendment No.	Page	Section	Description of amendment
08.02.10 AM	01	1	7. WIRING DIAGRAM	Layout revised, Section on the installation of terminals on valve actuators added
16.11.10 MC	02	2	4.2	Add new period : WARNING : to carry out



Head Office & Sales
 Via San G.B. De La Salle, 4/a Tel. +39 022722121
 20132 - Milano Fax +39 022593645
 Orders Fax +39 0227221239
 Reg. Off. Central & Southern
 Via S. Longanesi, 14 Tel. +39 065573330
 00146 - Roma Fax +39 065566517
 Shipping
 Via Gen. Treboldi, 190/192 Tel. +39 0364773200
 25048 - Edolo (BS) Tel. +39 0364773202
 E-mail: info@coster.info Web: www.coster.eu



D 25051