

ACTUATORS FOR DAMPERS WITH SPRING RETURN (max. 0.4 m² - 2 Nm)



CFT 02.. – CFT 004 Eng.

- **Power supply:**
 - CFT ..8 (230 V~) - CFT ..4 (24 V~/-)
- **Electric control:**
 - SPST (On-Off)
 - progressive 2 ... 10V- (CFT 004)
- **Rotation:**
 - angle max. 95°
 - run time 75 s (150 s - CFT 004)
 - time to emergency 25 s
- **Installation:**
 - directly on damper shaft



1. APPLICATION

CFT ... actuators are designed for the operation, with linear rotary movement, of dampers in ventilating and air-conditioning sites. Their available torque (2 Nm) permits operating dampers up to 0.4 m² provided that these have a very well-balanced movement.

2. MODELS

code	Power supply & consumption	Max angle	Run time	Emergency time	Torque	Control	Auxiliary switch supplied
CFT 028	230 V~ ± 10% (5 VA)	95°	75 s	25 s	2 Nm	SPST	—
CFT 028/C	230 V~ ± 10% (5 VA)	95°	75 s	25 s	2 Nm	SPST	1 SPDT
CFT 024	24 V~/– ± 20% (5 VA)	95°	75 s	25 s	2 Nm	SPST	—
CFT 024/C	24 V~/– ± 20% (5 VA)	95°	75 s	25 s	2 Nm	SPST	1 SPDT
CFT 004	24 V~/– ± 20% (4 VA)	95°	150 s	25 s	2 Nm	2...10 V–	—

3. ACCESSORIES (optional)

Code	Description
PCS 104	Built-in manual positioner 0 ... 100% (only for actuators with 2 ... 10 V– control).
KH 8	Universal crank arm for damper shafts; (ø 10 ... 18 mm. - □ 10 ÷ 14 mm.).
AH-TF	Actuator arm (specific for CFT actuators).
KG 10	Ball joint for connection (for rods with ø 10 mm. max.).
ZG-TF1	Kit for mounting actuators on the flat (specific for CFT actuators).

4. TECHNICAL DATA

Power supply:		Type of control	see "Models"
– CFT ..8	230 V~ ± 10%	Electrical connections: (pre-set)	
– CFT ..4	24 V~/– ± 20%	– CFT 02.. (1 cable: control)	1m, 2 x 0.75 mm ²
Frequency	50...60 Hz	– CFT 02../C (2 cables: control & auxiliary switch)	1m, 3 x 0.75 mm ²
Consumption:		– CFT 004 (1 cable: power & control)	1m, 4 x 0.75 mm ²
– CFT ..8/4	5 VA (2.5 W)	Ambient temperature:	
– CFT 004	4 VA (2.5 W)	– operation	– 30...+50 °C
Torque	2 Nm	– transport & storage	– 40...+80 °C
Run times / Emergency	see "Models"	Humidity	95% (EN 60730-1)
Direction of rotation	according to installation	Protection	IP 42
Rotation angle	max.95°(adjustable)	Weight:	about 650 g

5. INSTALLATION

Before attaching the actuator to the damper, carry out the following preliminary checks in order to avoid any difficulties at the moment of installation.

Check:

- that there is sufficient space available for installing the actuator; plenty of room is essential
- the dimensions of the dampers (max. 0.4 m²) and their balance on the shaft.
- that the actuator has all the parts necessary for its correct installation.

The actuator must be installed directly on the damper shaft (for details see section 8). Position the damper at about half run, insert the actuator on the shaft and, using the anti-torsion adjustable bracket supplied, secure it; secure also the shaft by means of the assembled motor block. Make the electrical connections observing the safety regulations in force.

N.B. To lengthen the cables supplied do NOT – repeat NOT - use telephone or similar cables. It is possible to connect several actuators in parallel, paying attention to their technical features. (max. 10).

6. OVERALL DIMENSIONS – DESCRIPTION

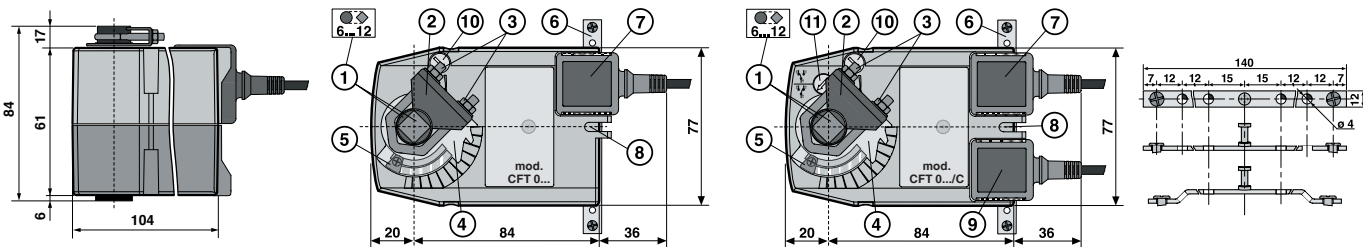

- 1 – Damper shaft
- 2 – Shaft clamp
- 3 – Shaft securing clamp
- 4 – Supporting bracket
- 5 – End-of-run stop
- 6 – Anti-torsion bracket
- 7 – Electric connections block
- 8 – Locking bracket housing
- 9 – Connection for auxiliary
- 10 – Rotation direction switch
- 11 – Auxiliary inversion switch

7. WIRING DIAGRAMS

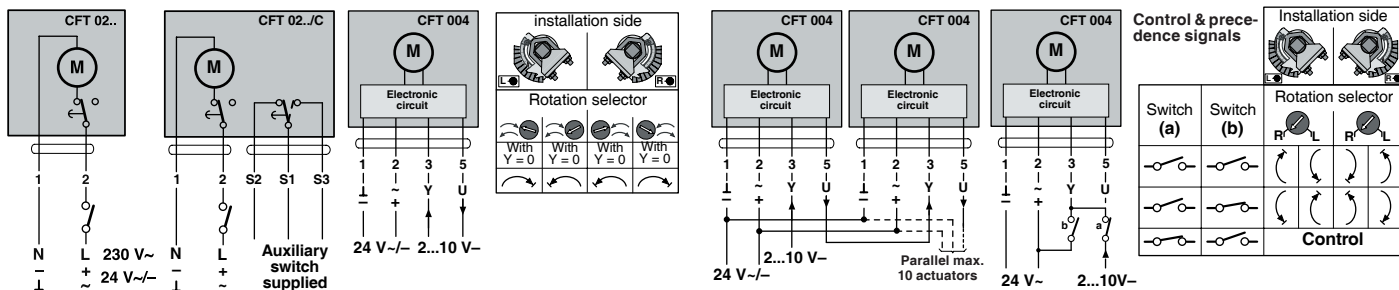

NB: Pay attention to synchronization of one actuator with another(± 5% tolerance).

8. INSTALLATION SEQUENCE

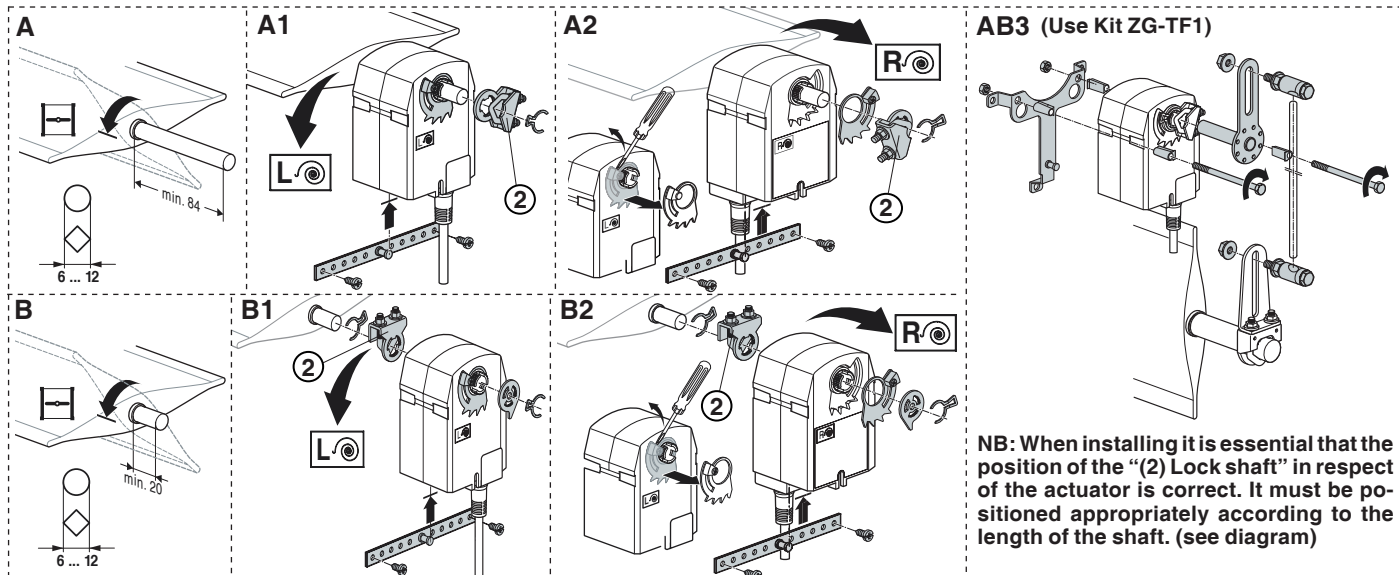

NB: When installing it is essential that the position of the “(2) Lock shaft” in respect of the actuator is correct. It must be positioned appropriately according to the length of the shaft. (see diagram)

Amendment to data sheet

Date	Revision No.	Page	Section	Amendments description
27.10.05 MC	-	-	General	Layout Data Sheet.
04.04.06 MC	-	1-2	General	Arrangement data & page layout.
		2	7. Wiring diagrams	Added: parallel wiring diagram & precedence controls with descriptive table.
		1	3. Accessories	Added: specific accessories for type of actuator (AH-TF, ZG-TF1).
11.12.08 MC	01	2	8. Installation sequence	Replaced all drawings and table at foot of page.



Head Office & Sales
 Via San G.B. De La Salle, 4/a Tel. +39 022722121
 20132 - Milano Fax +39 022593645
 Orders Fax +39 0227221239
 Reg. Off. Central & Southern
 Via S. Longanesi, 14 Tel. +39 065573330
 00146 - Roma Fax +39 065566517
 Shipping
 Via Gen. Treboldi, 190/192 Tel. +39 0364773200
 25048 - Edolo (BS) Tel. +39 0364773202
 E-mail: info@coster.eu Web: www.coster.eu



D 33335

